

# PROJECT OVERVIEW



## Project Goals

- Improve safety
- Improve predictability
- Reduce speeding
- Reduce collisions
- Connect bike network

## Proposal

- Add bike lanes to Banner Way NE and NE 75th St
- Update intersection of 75th Ave NE and Roosevelt Way NE
- Update intersection of 75th Ave NE and Lake City Way NE
- Refresh crosswalk paint and other safety markings
- Consolidate on-street parking

## Vision Zero

Vision Zero is our plan to end traffic deaths and serious injuries by 2030. Seattle is consistently recognized as one of the safest cities in the country. Over the past decade, we've seen a 30% decline in traffic fatalities, even as our population has grown. We are currently on-target to achieve our goals.

# BACKGROUND

## Network connections

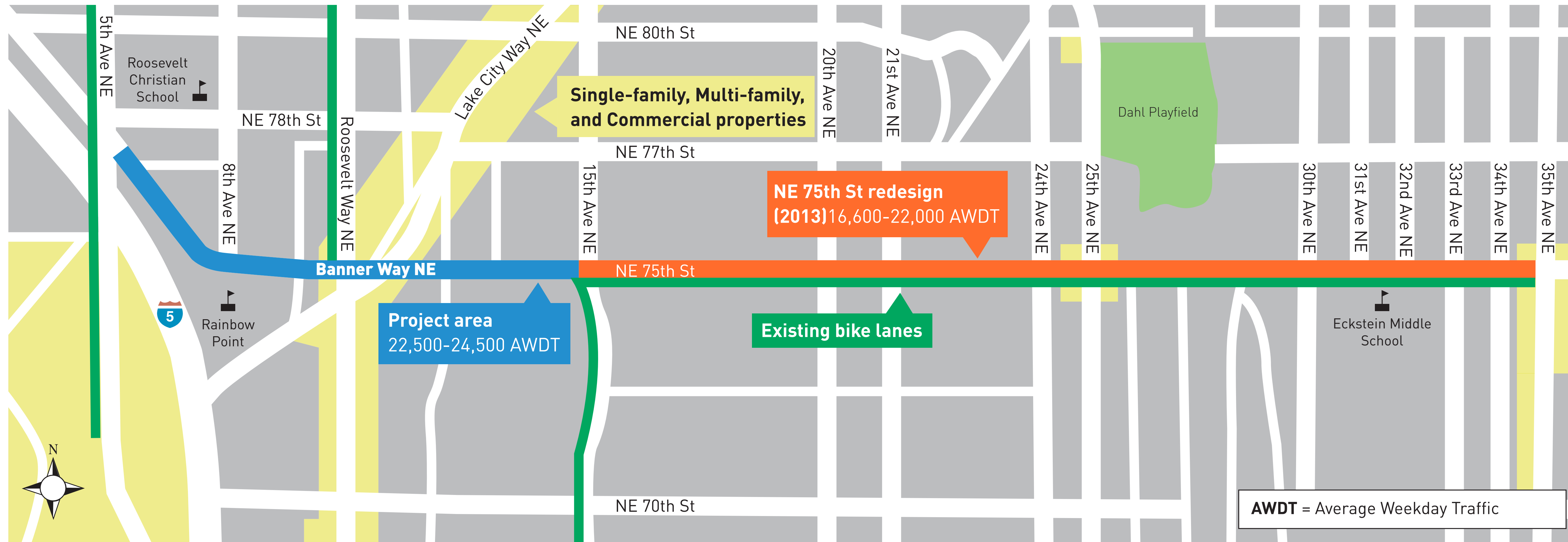

## Community engagement activities:

- **March 2016:** Mailing, community meeting with traffic data, design concepts
- **April 2016:** Mailing, walk and talk with neighbors
- **June 2016:** Group bike ride
- **October 2016:** Mailing, walk and talk with neighbors
- **October 2016:** Mailing, open house

# COLLISION HISTORY

## 2013 – 2016: Banner Way NE, NE 75th St

- 83 collisions total
- 3 serious injury collisions (2 pedestrian-involved)
- 4 pedestrian-involved collisions
- 2 bicycle-involved collisions

## 2013-2016: Bike, pedestrian collision locations

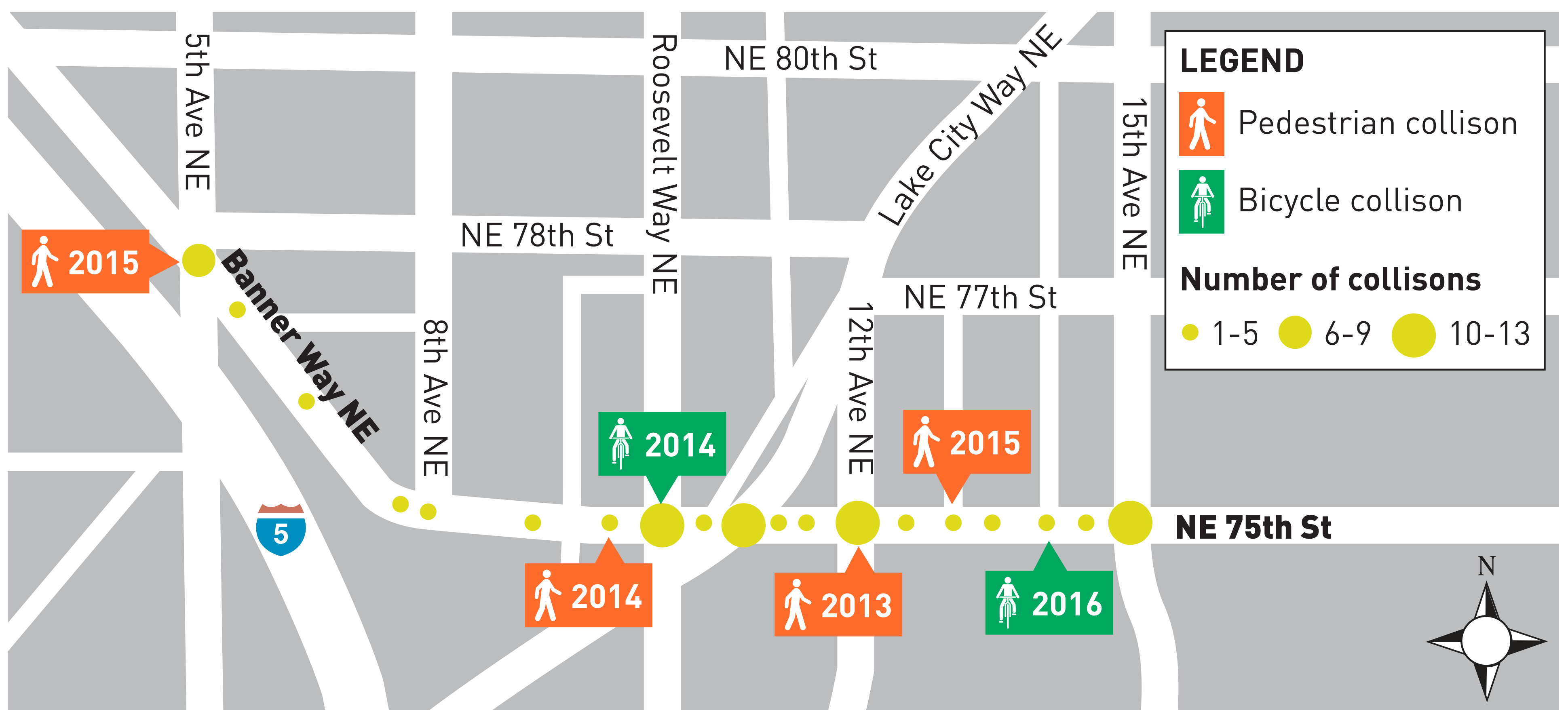

4-year collision history by type

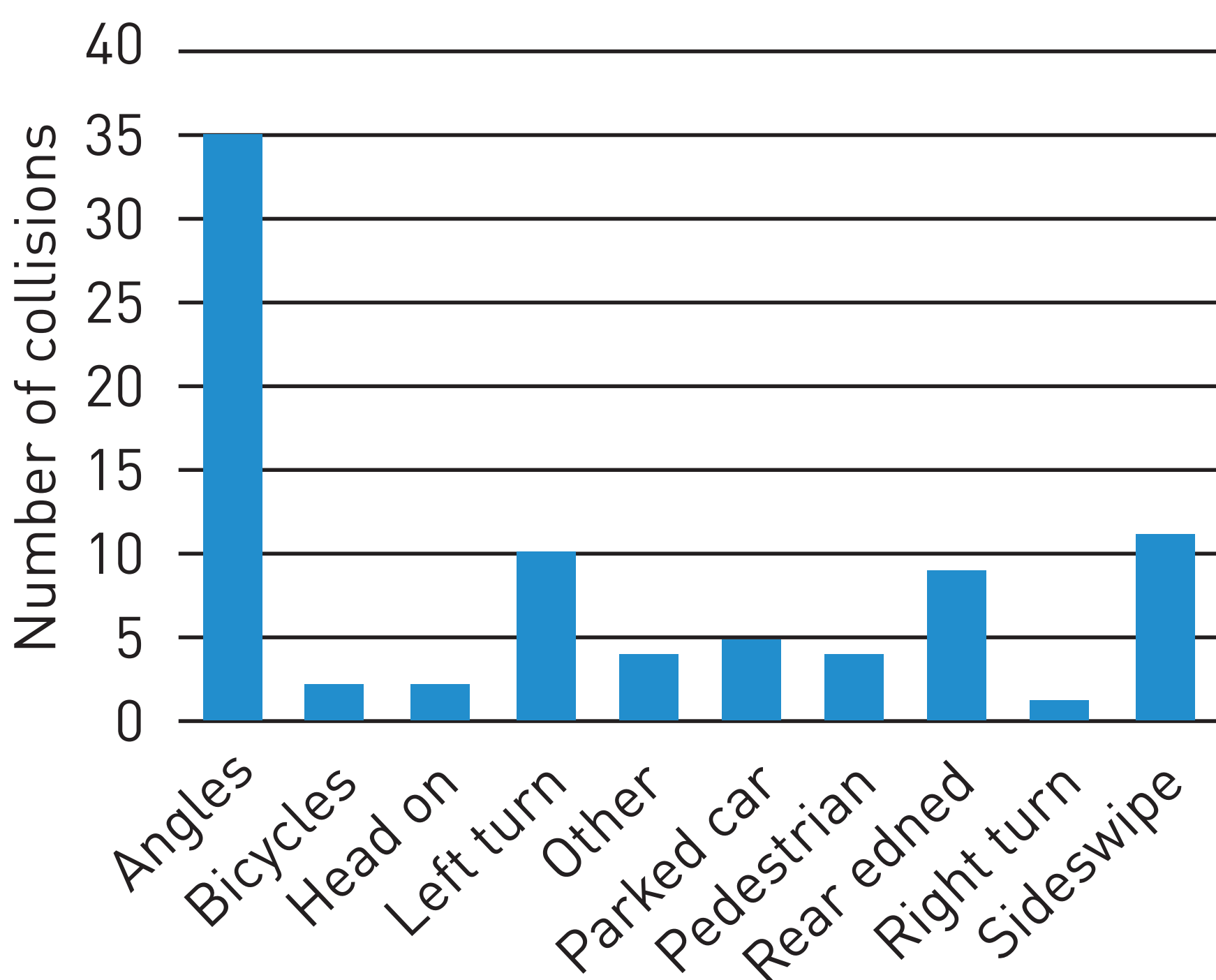

10-year collision history by type

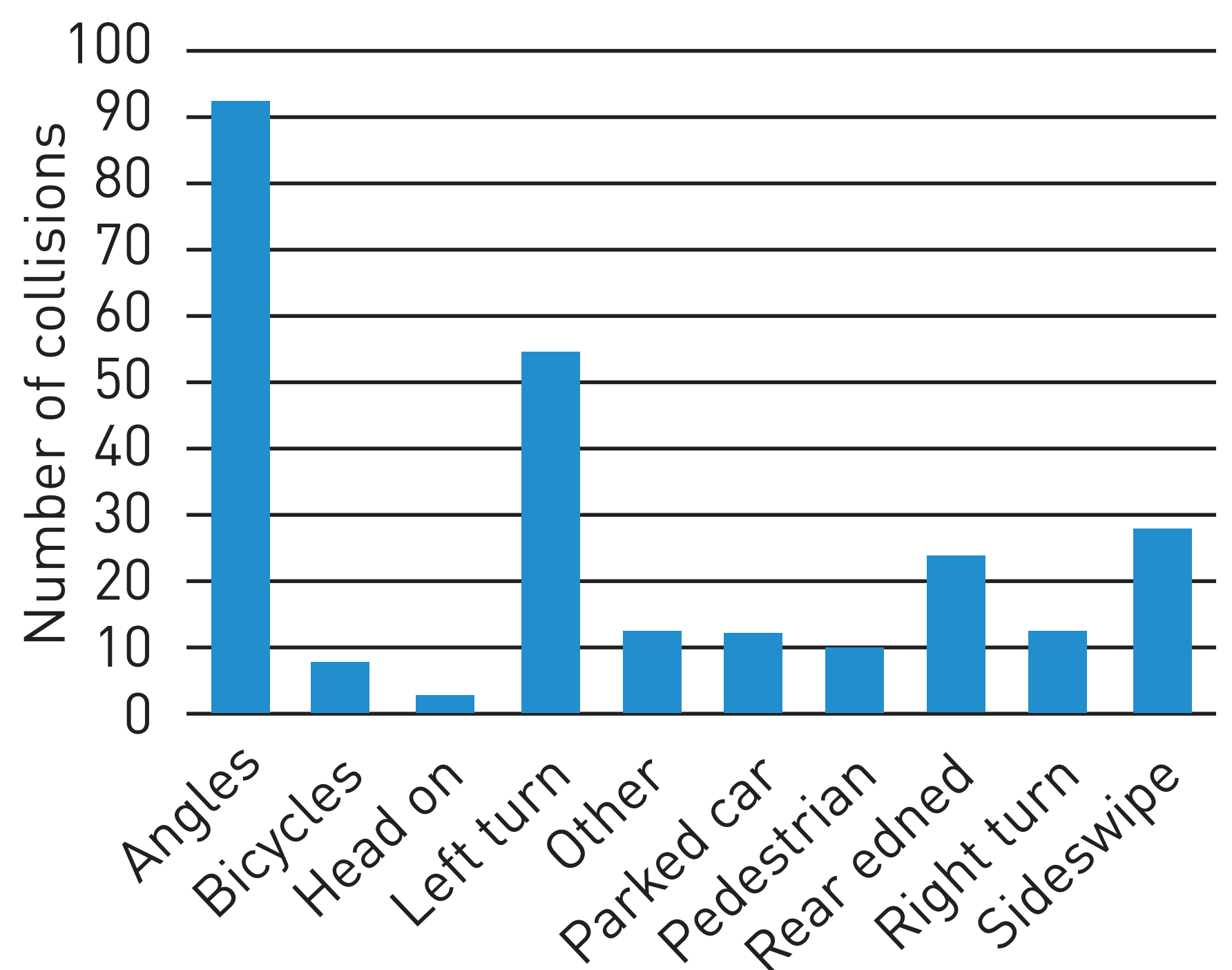



# PARKING UTILIZATION

## Early morning (5 – 7AM)

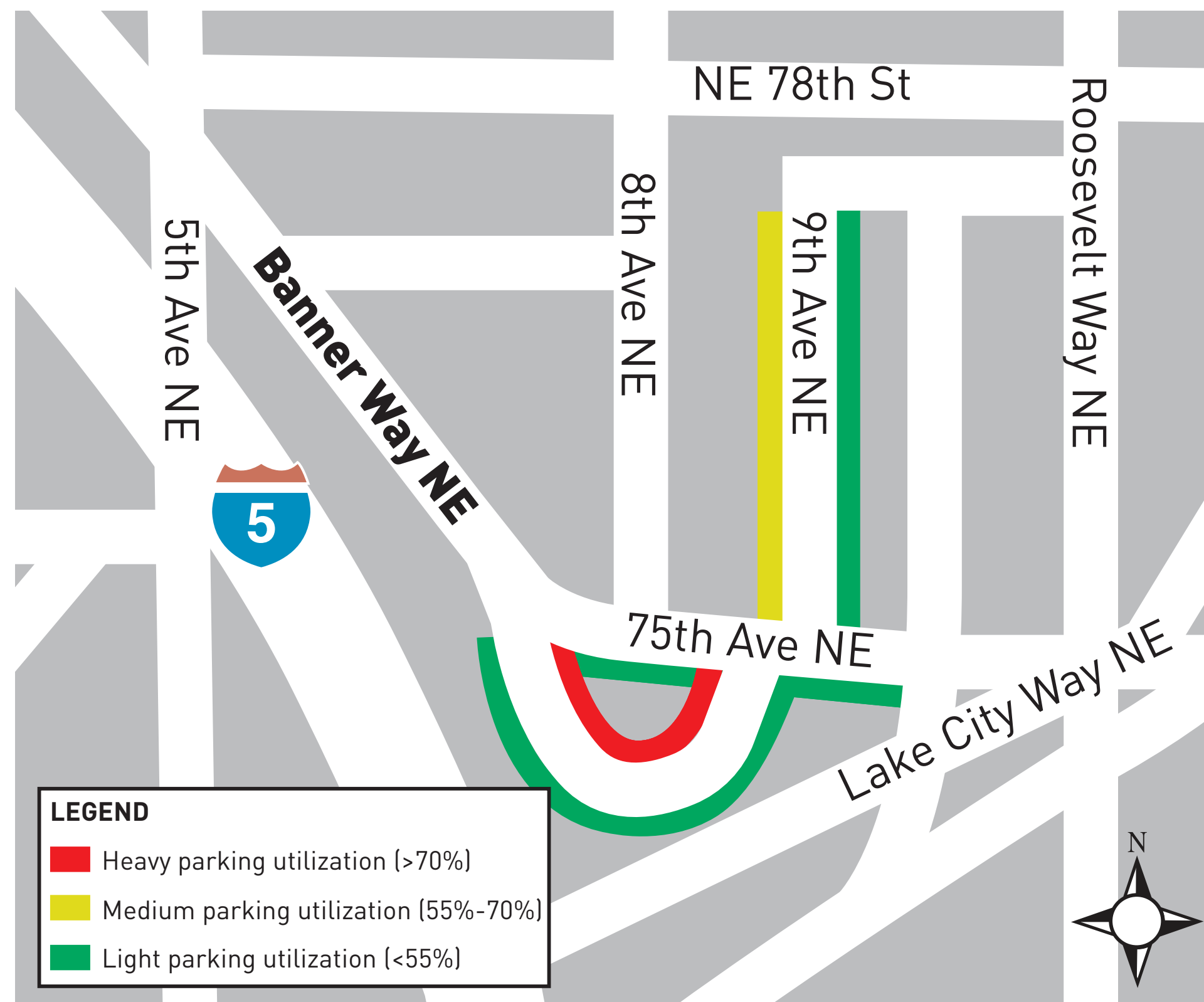

## Midday (10AM – 2PM)

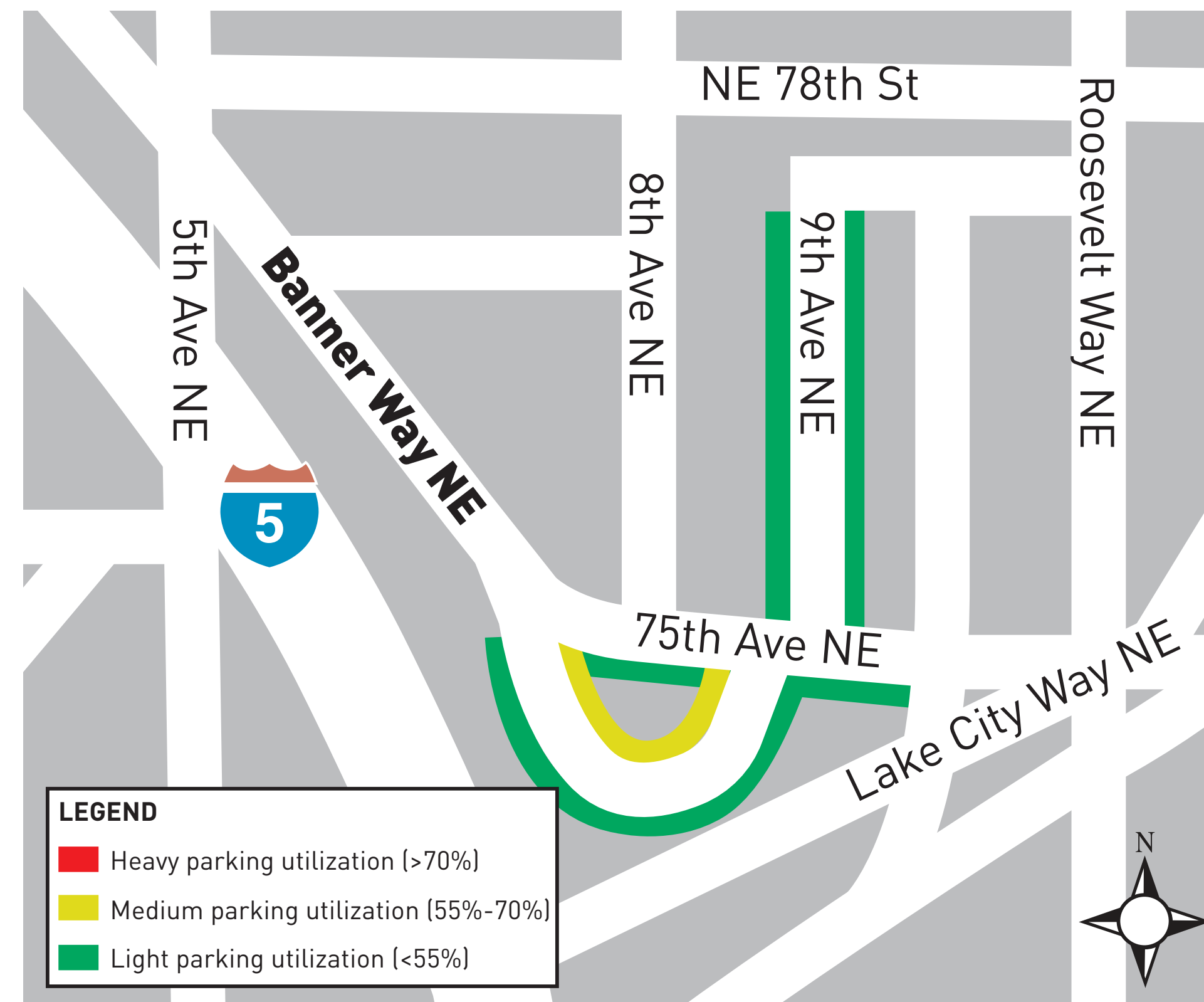

## Evening (6 – 7PM)

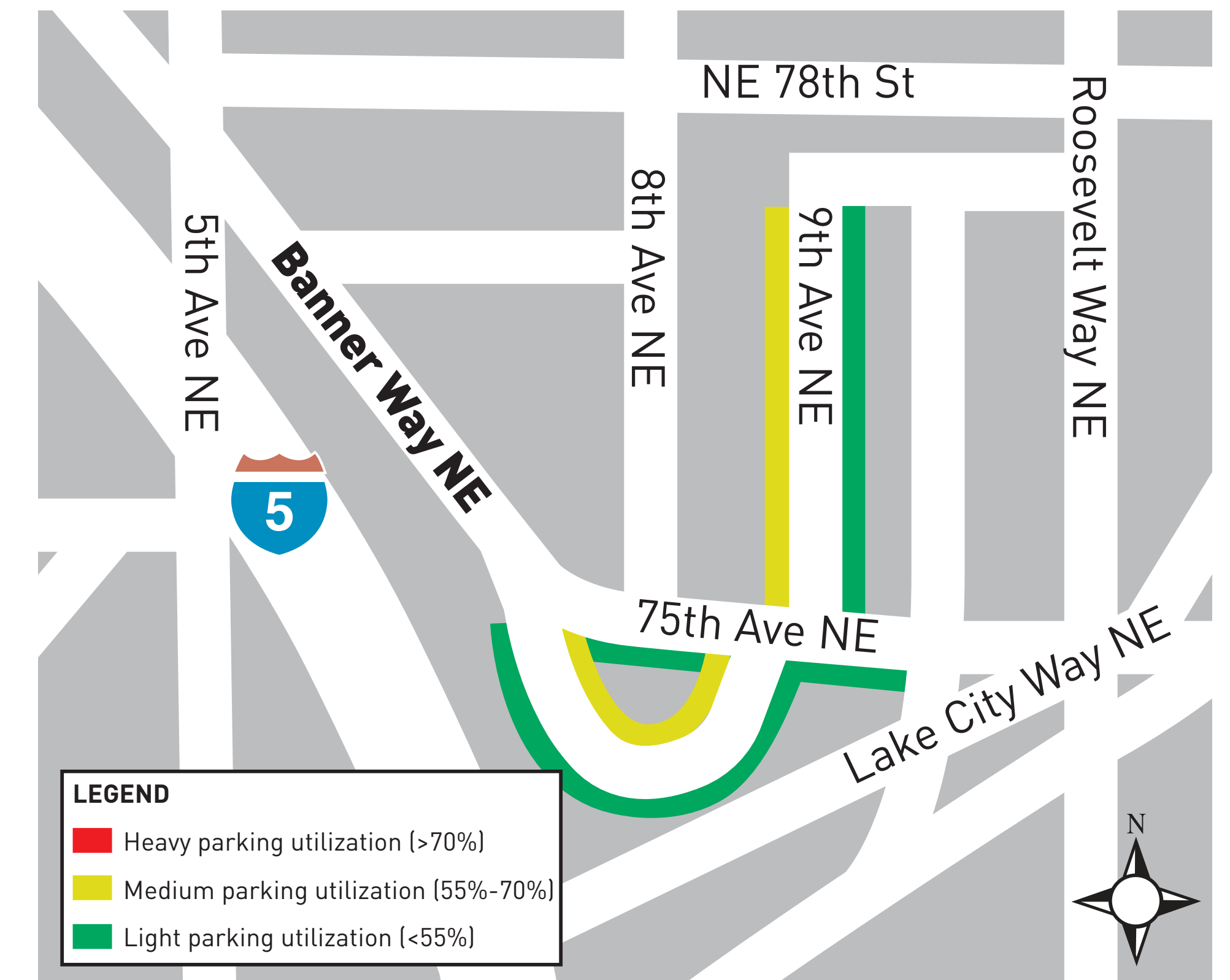

Count date: Tuesday, February 2, 2016 Times of day: 5 – 7 AM, 10 AM – 2PM, 6 – 7 PM

**What we've heard:** Along the Banner Way NE curve, parking utilization is “light” due to vehicles speeding around the curve and losing control. Guardrails have also been installed in response to crashes that are often a result of the high speeds around the curve.

# PROPOSED CROSS SECTIONS

## Banner Way NE and NE 75th St

- Buffered bike lanes on Banner Way NE curve
- Standard bike lanes on NE 75th St
- Connections to bike facilities on 5th Ave NE, Roosevelt Way NE, NE 75th St

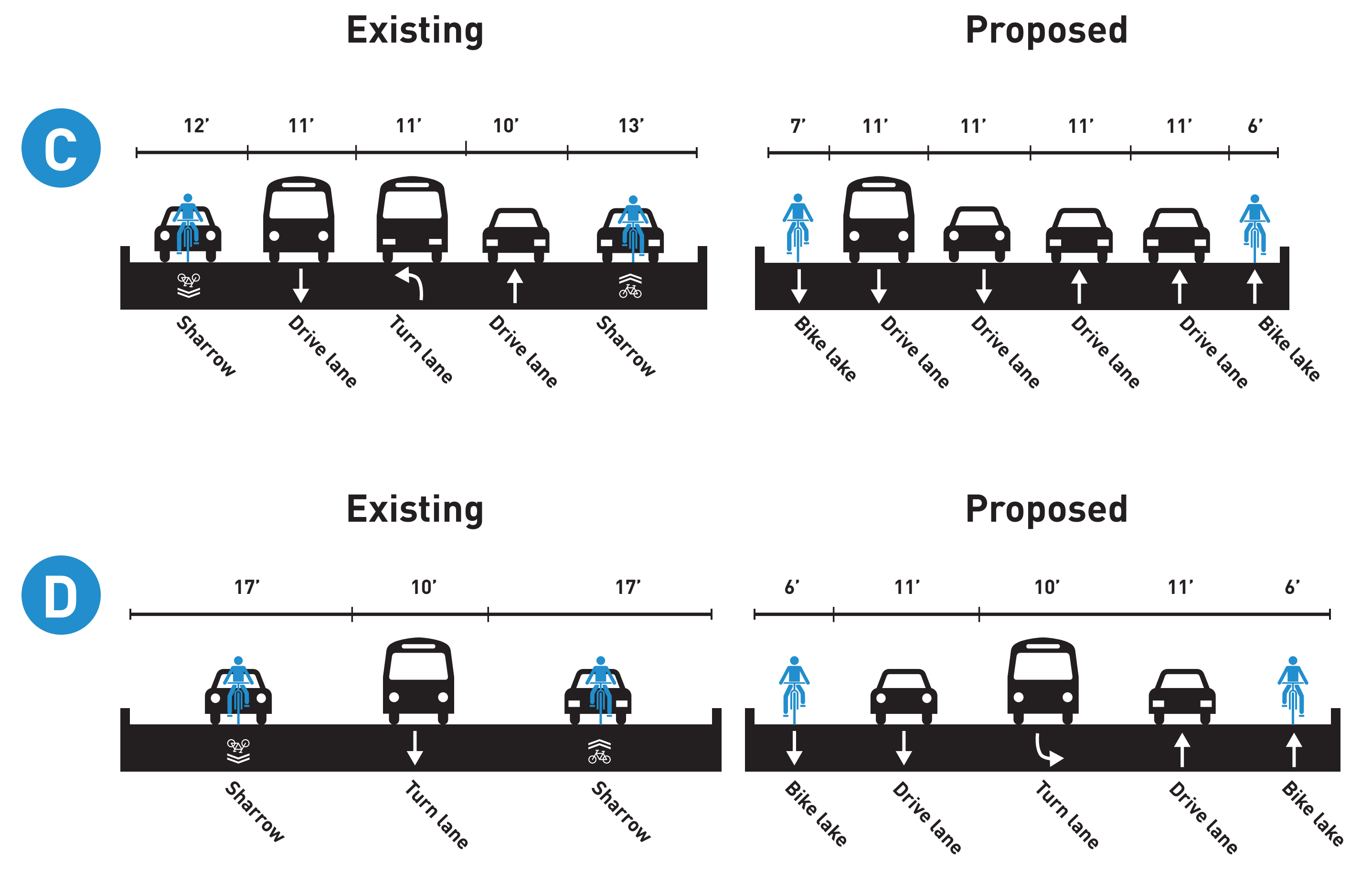
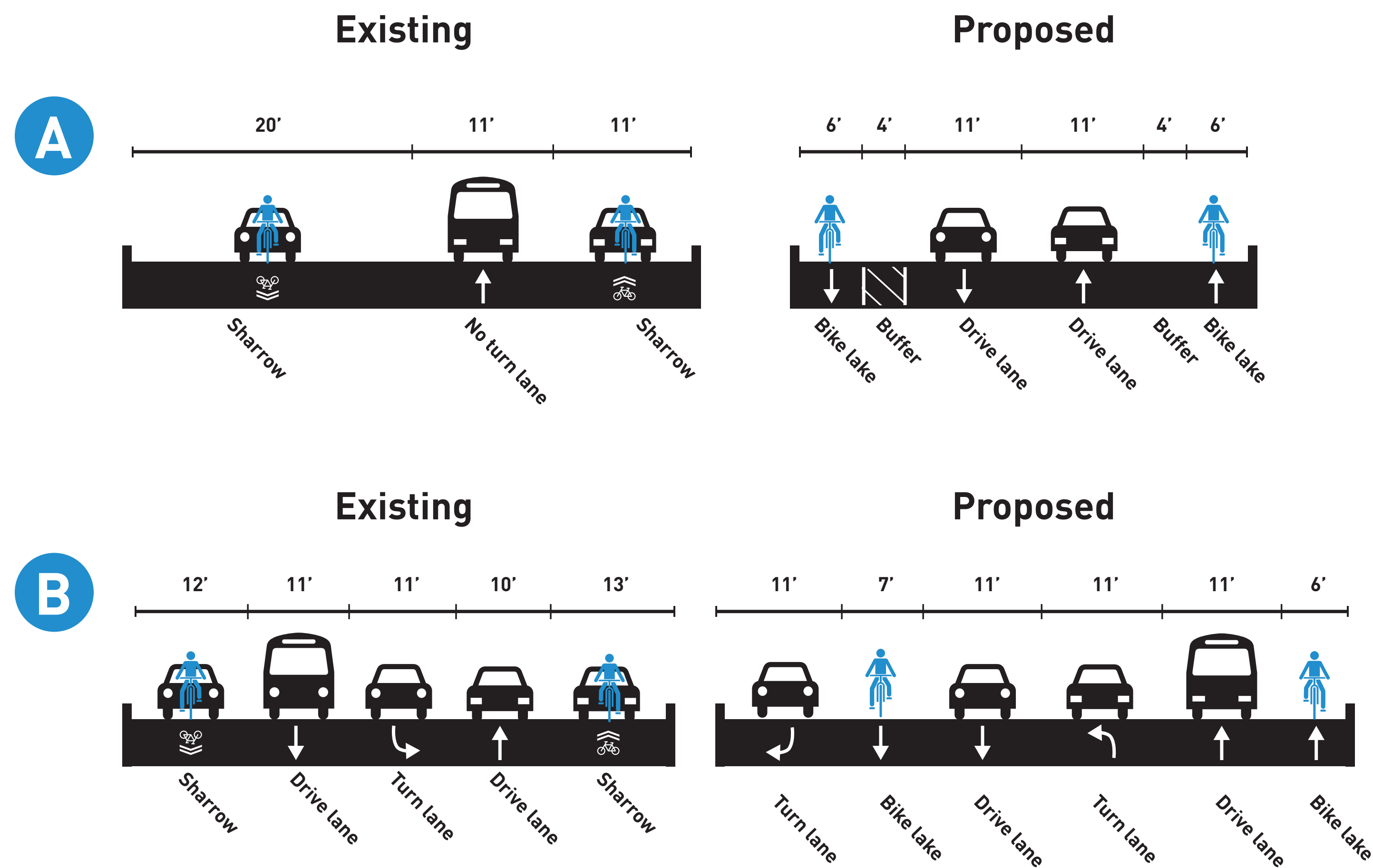
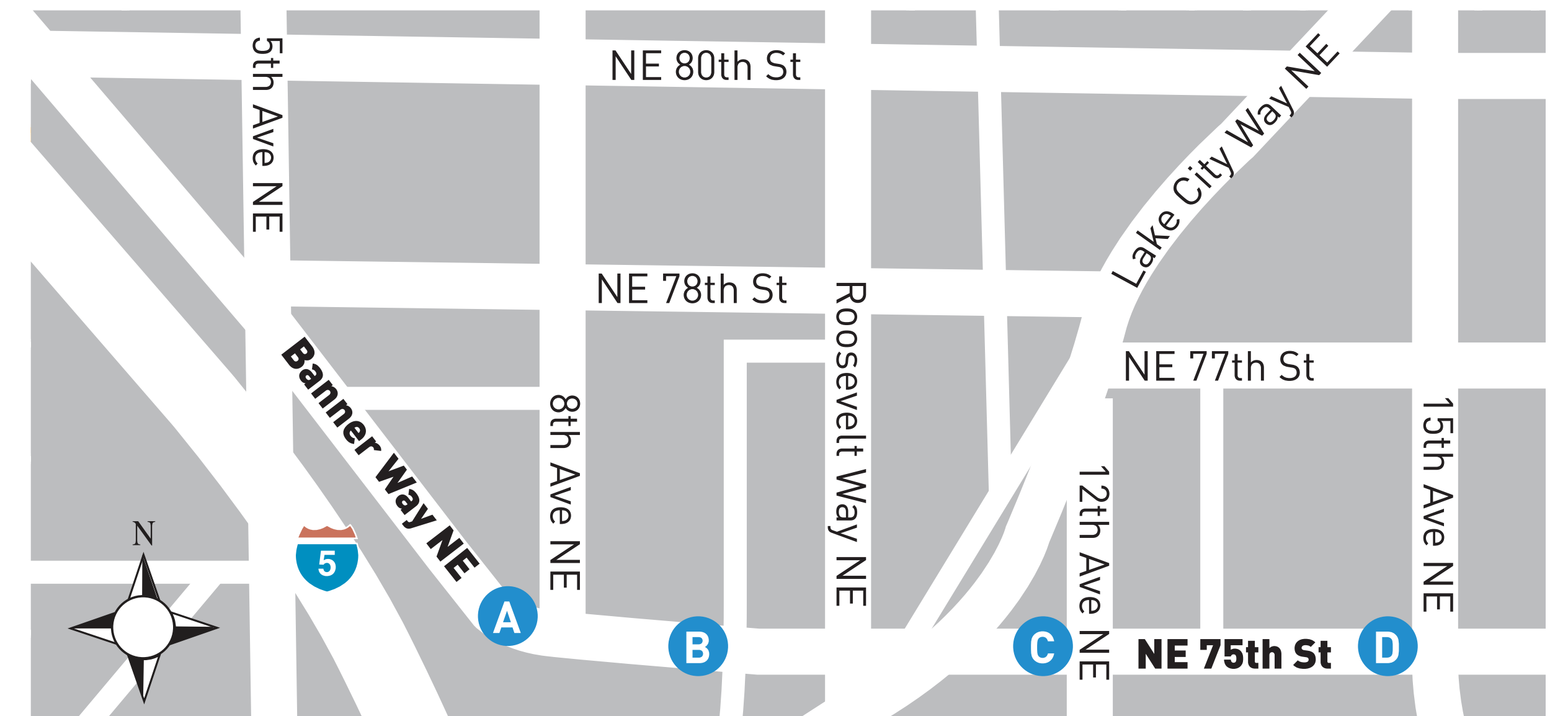



# UPDATING INTERSECTION DESIGN

## 75th Ave NE and Roosevelt Way NE

- New left-turn signal installed for southbound Roosevelt to eastbound 75th
- New painted area, street markings to better define lanes, reduce confusion
- Remove left-turn from eastbound 75th to northbound Roosevelt
- Remove left-turn from westbound 75th to southbound Roosevelt
- NO TURNS allowed going eastbound through Lake City Way NE

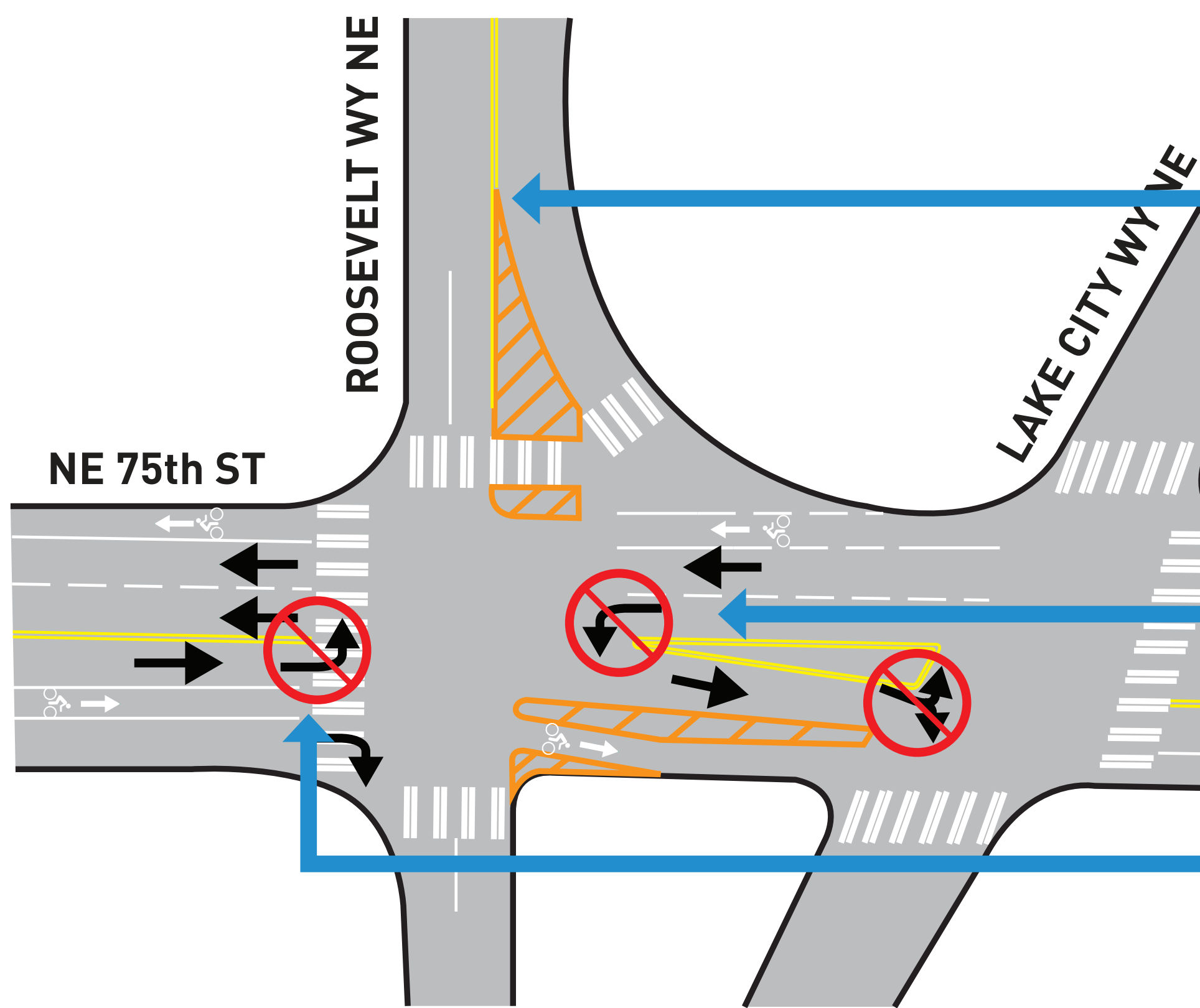

Painted to visually discourage drivers from turning left from Banner Way NE to Roosevelt Way NE.

**Left turns will no longer be allowed onto Roosevelt Way NE.** Our traffic counts show low turning movements:

- **AM peak hour:** 6 vehicles
- **PM peak hour:** 4 vehicles

**Left turns will no longer be allowed onto Roosevelt Way NE.** Our traffic counts show low turning movements:

- **AM peak hour:** 11 vehicles
- **PM peak hour:** 10 vehicles

## 75th Ave NE and Lake City Way NE

- New left-turn signal installed for eastbound 75th to southbound Lake City Way

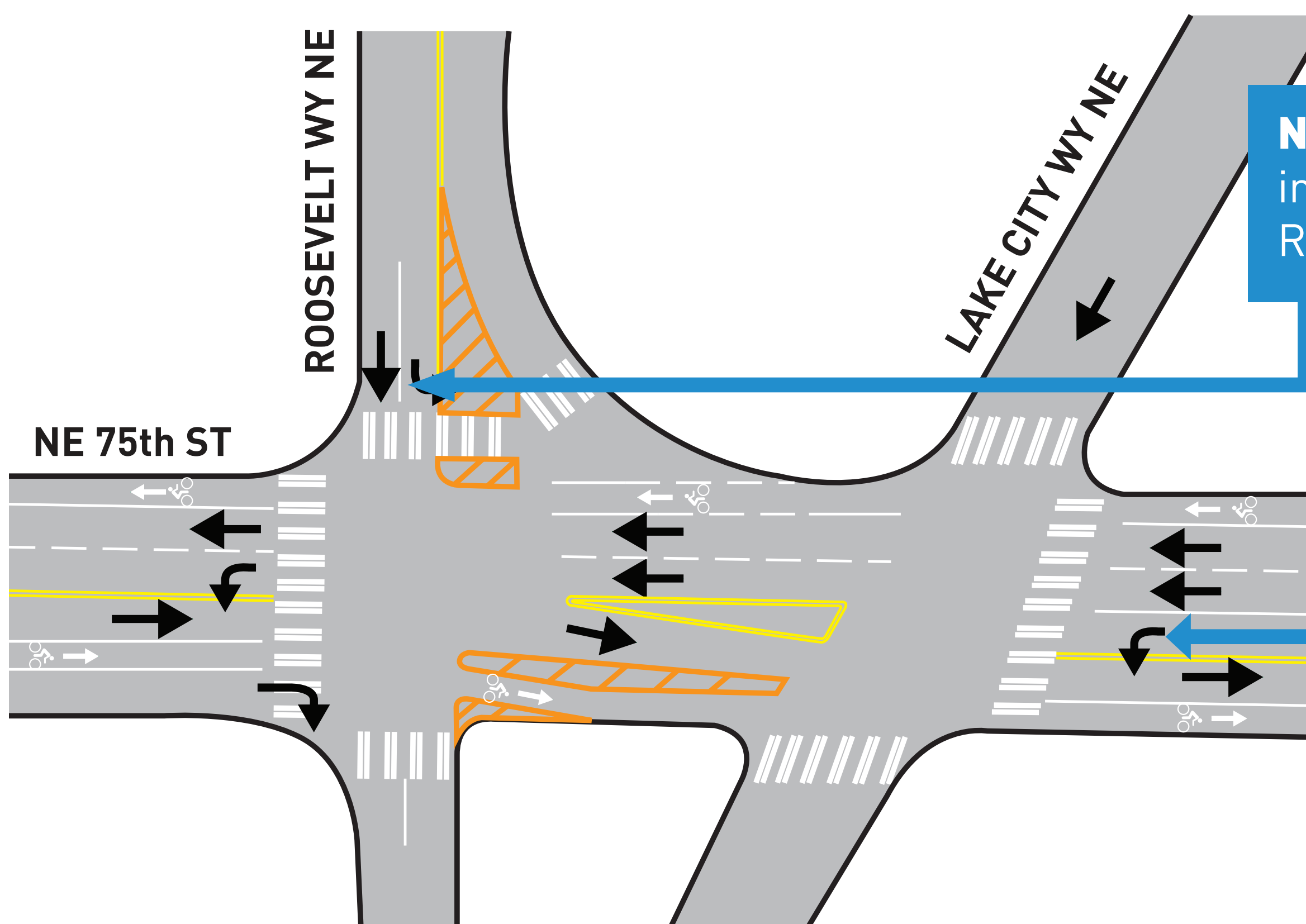

**New left-turn traffic signal** will be installed for vehicles turning left into Roosevelt Way NE.

**New left-turn traffic signal** will be installed for vehicles turning left into Lake City Way NE.

# TRAFFIC SIGNAL COORDINATION

To accommodate the new lane configurations, we will update the traffic signal cycle s and coordinate signal timing along the corridor.

Location	AM		PM	
	Existing Cycle Length	New Cycle Length	Existing Cycle Length	New Cycle Length
<b>Roosevelt Way NE &amp; NE 75th St</b>	70 secs	80 secs	90 secs	100 secs
<b>Lake City Way NE &amp; NE 75th St</b>	70 secs	80 secs	90 secs	100 secs
<b>12th Ave NE &amp; NE 75th St</b>	70 secs	80 secs	90 secs	100 secs
<b>Roosevelt Way NE &amp; NE 73rd St</b>	90 secs	80 secs	90 secs	100 secs

# TIMELINE

## Banner Way NE Road Safety Corridor Project

### Short-term (late 2016 or early 2017)

- New channelization
- New bike facilities
- Signal timing updates

### Mid-term

- New curb ramps
- new marked crossing between 8th Ave NE, NE Banner Place
- Coordinate with Sound Transit on new curb ramps at 5th Ave NE, Banner Way NE
- Evaluate effectiveness of improvements
- Release before-and-after report

### Long-term

- Potential traffic signal at 5th Ave NE, Banner Way NE

## QUESTIONS OR COMMENTS?

James Le | 206-684-3174 | [james.le@seattle.gov](mailto:james.le@seattle.gov)

