

IMPROVEMENTS: OPEN LAWN AREAS, VIEWPOINT, TRAILS
FOOT/BIKE PATH

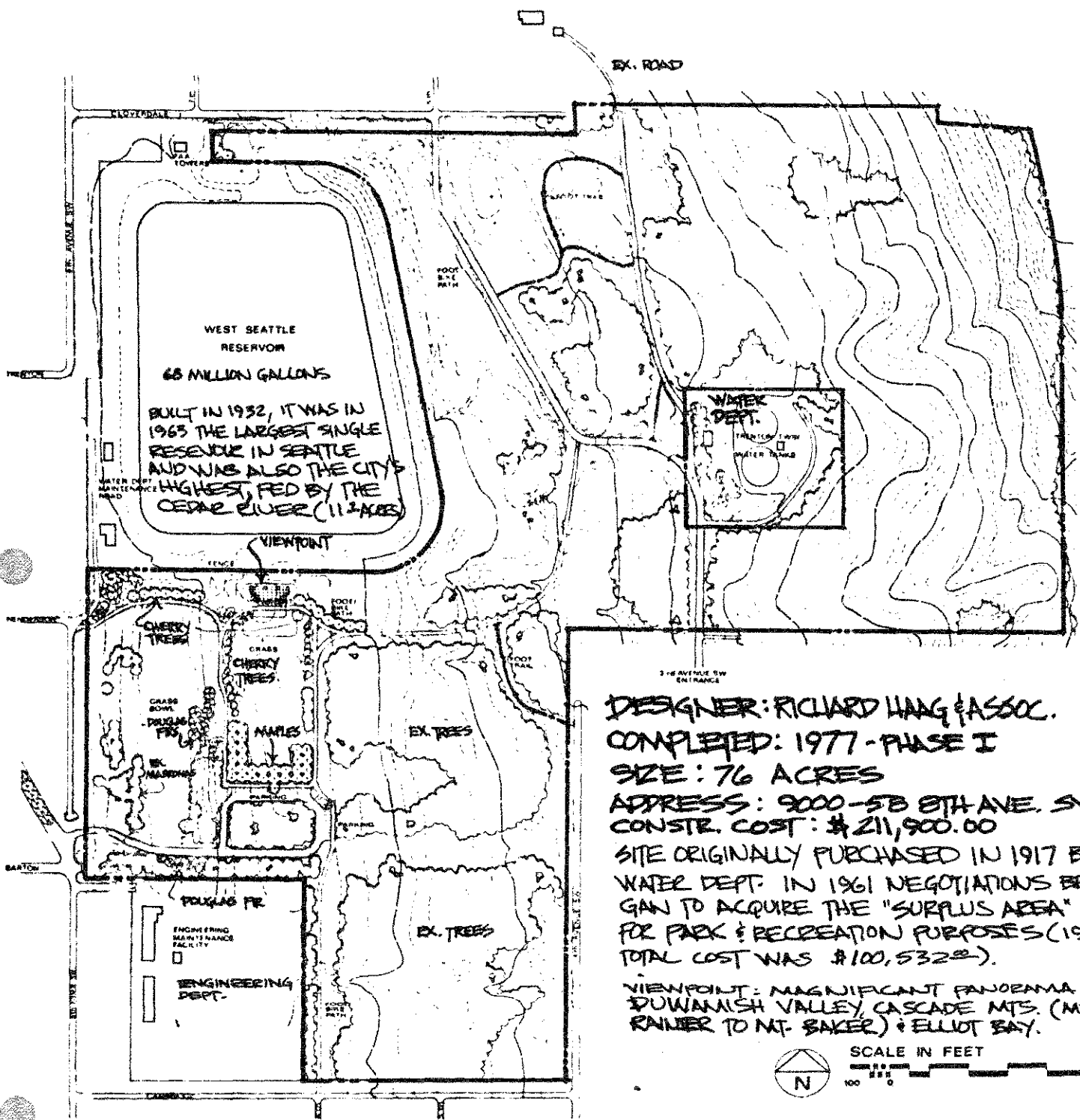

DESIGNER: RICHARD HAAG & ASSOC.
 COMPLETED: 1977 - PHASE I
 SIZE: 76 ACRES
 ADDRESS: 9000-58 8TH AVE. SW.
 CONSTR. COST: \$211,900.00
 SITE ORIGINALLY PURCHASED IN 1917 BY
 WATER DEPT. IN 1961 NEGOTIATIONS BE-
 GAN TO ACQUIRE THE "SURPLUS AREA"
 FOR PARK & RECREATION PURPOSES (1917
 TOTAL COST WAS \$100,532.00).
 VIEWPOINT: MAGNIFICANT PANORAMA OF
 DUWAMISH VALLEY, CASCADE MTS. (MT.
 RAINIER TO MT. BAKER) & ELLIOT BAY.

634

WESTCREST PARK

062976 DNS REVISED 7-14-77 DYS