

(LOFT = 49 people)  
for BAND  
STAGE  
PICNIC USES.

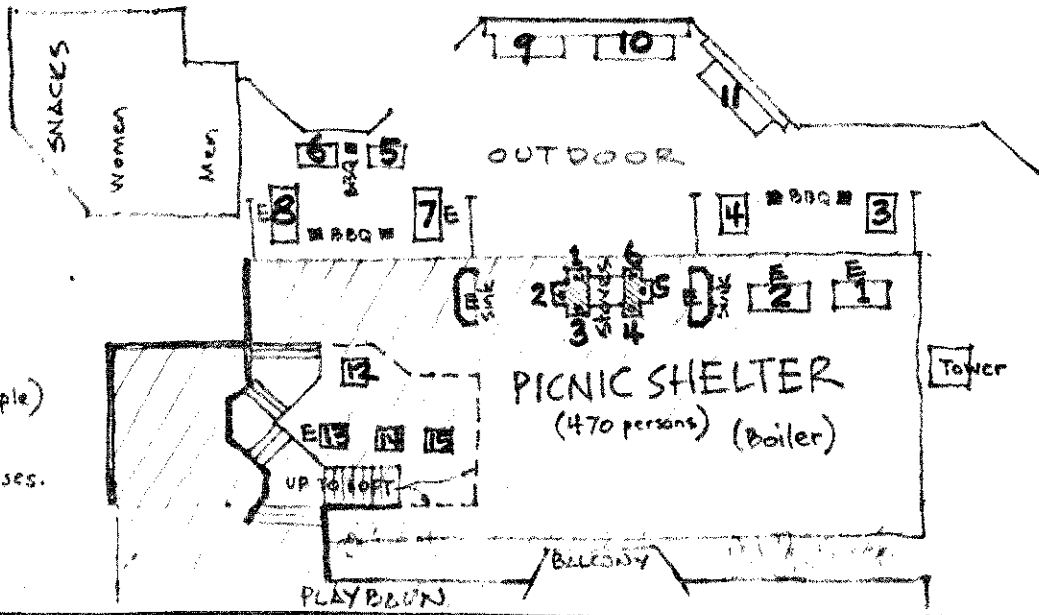

PICNIC TABLES  
that may be reserved:  
Nos. 1, 2, 7 + 8 = 14 persons each  
Nos. 3, 4, 5 + 6 = 10 persons each  
Nos. 12, 13, 14 + 15 = 8 persons each  
Nos. 9, 10 + 11 = 14 persons ea/not reserved  
E = Electric Outlets  
BBQ = Charcoal Burners

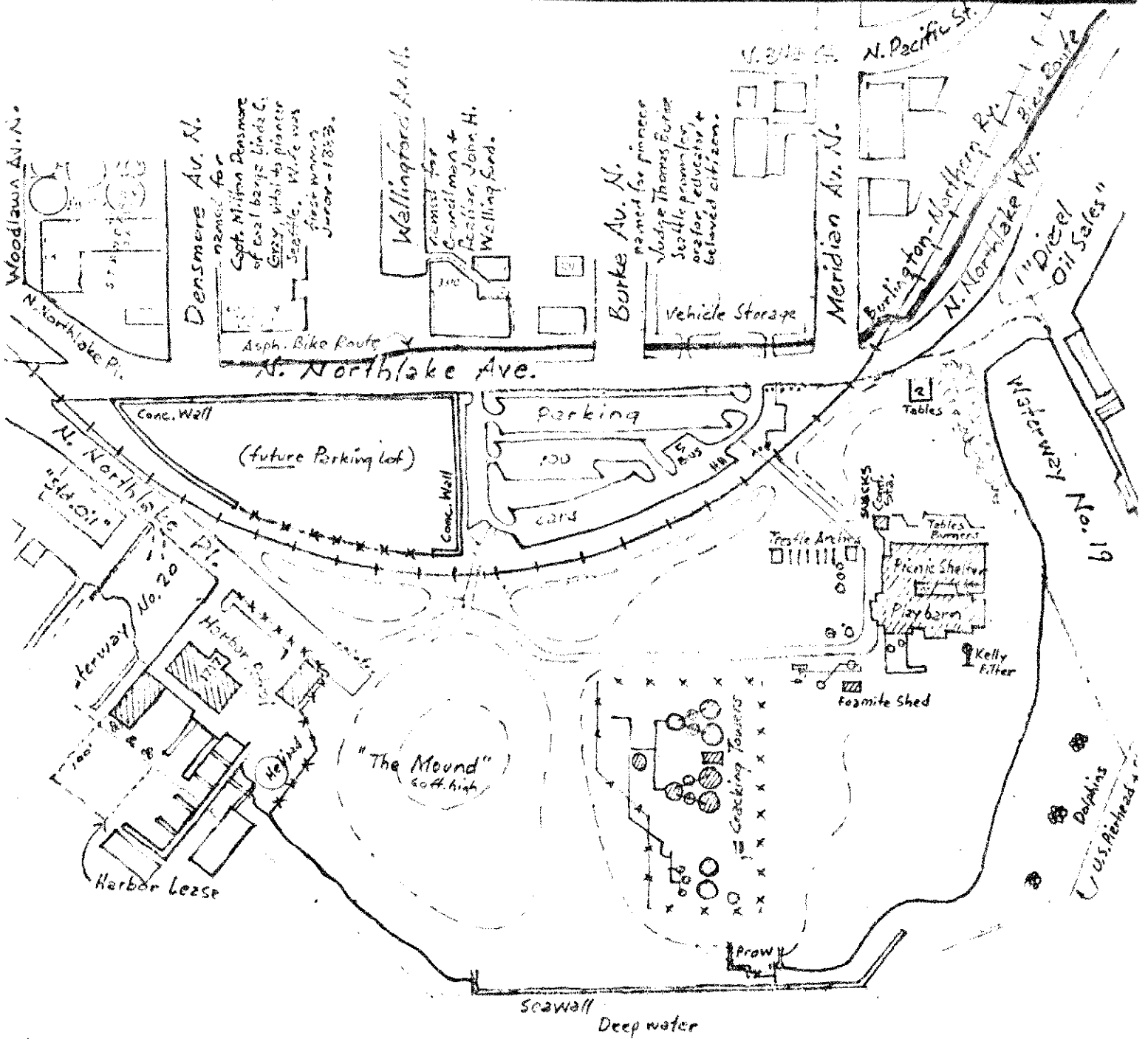

↑ NORTH  
113  
Union

2000 N. Northlake Way  
**GAS WORKS PARK**

20.75 Ac.  
Incl. 0.6 Ac. Shorelands  
+ Harbor Lease = 0.25 Ac.  
shoreline 1900 line.  
Transf. 1963 (\$45,000 @ '60 &  
from Water Dept.  
Purch. 1963-73 (\$1,526,352 @ '61  
from Gas Co. - 10 yr. term contract  
"for park, public use + ship base"  
Cadden 1964 - \$37,000 @ '60 + \$17,500  
+ Harbor lease - \$1500 @ '60  
for park, etc.  
+ loading +

062476

